

CLIFF WALK LANDSCAPE

Expansion of Native Plant Communities

Habitat for birds and pollinators will be improved by using an incremental and phased process to suppress invasive plants, while preserving existing remnant native plant communities and creating conditions more conducive to their spread across the site. To be successful in the long-term, the scope and schedule for landscape restoration should work in conjunction with optimal treatment strategies for managing invasive species.

Inventory of Native & Beneficial Plants:

- 26 Species of Trees, Shrubs, & Vines
- 14 Species of Herbaceous Plants

Existing Native Plant Locations

- 1) Aster-goldenrod meadow
- 2) Northern Bayberry group
- 3) Cherry shrub species
- 4) Common juniper
- 5) Northern bush honeysuckle thicket
- 6) Eastern red cedar
- 7) Hawthorn – pin cherry thicket
- 8) Bayberry, chokeberry, Virginia rose, raspberry, pin cherry, shadbush patch

Restoration Strategy

- Nurture native and beneficial plants that already exist on-site, and add more of same species where appropriate
- Improve soil conditions to favor the growth of native plants, by increasing carbon and reducing nitrogen
- Improve diversity and vertical structure of the site's flora
- Infill existing canopy cover
- Enhance and expand shrub layer
- Plant to stabilize areas cleared of invasive plants
- Select additional plants and plant species for their ability to provide valuable food sources, cover, and nesting opportunities

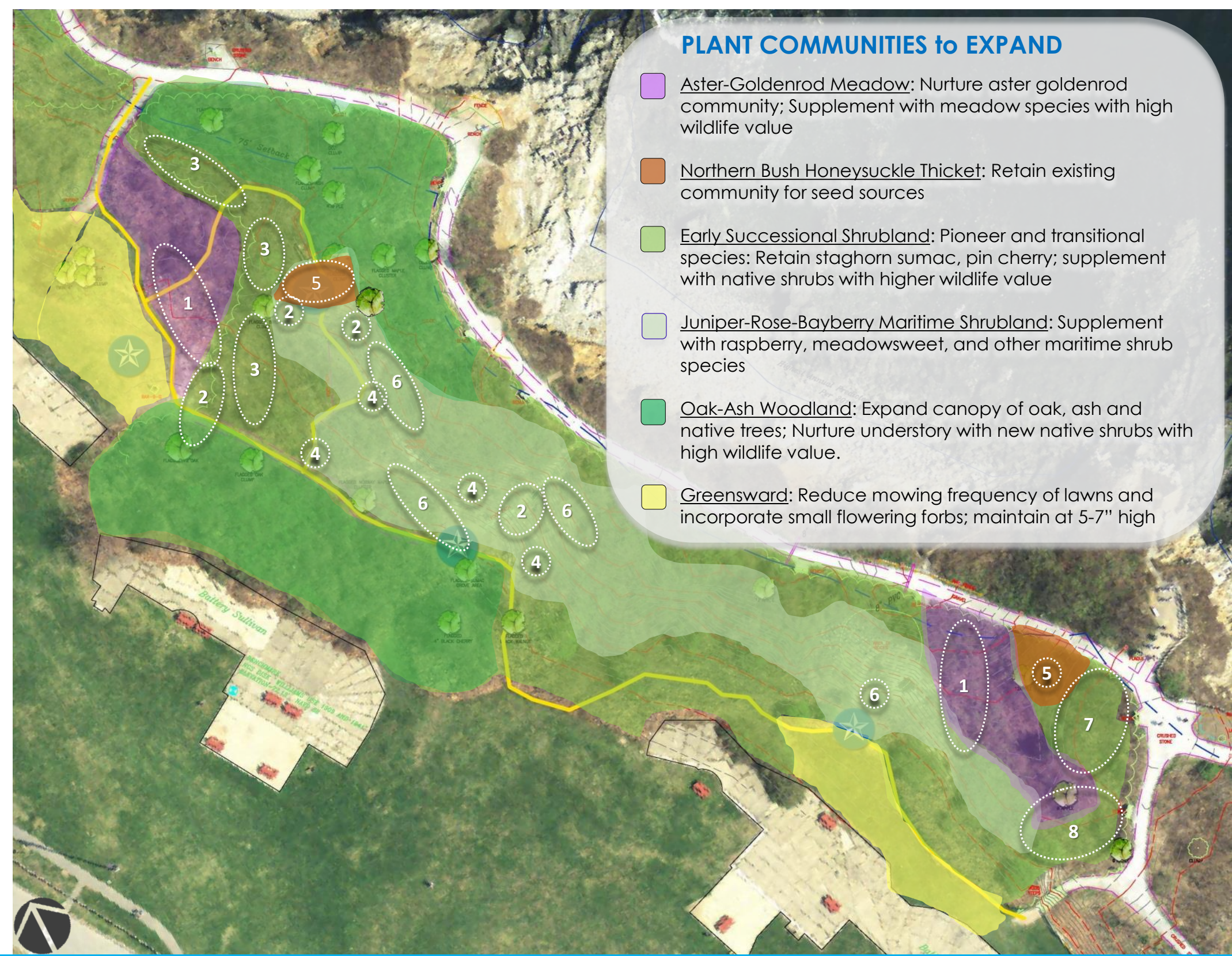

PLANT COMMUNITIES to EXPAND

- Aster-Goldenrod Meadow: Nurture aster goldenrod community; Supplement with meadow species with high wildlife value
- Northern Bush Honeysuckle Thicket: Retain existing community for seed sources
- Early Successional Shrubland: Pioneer and transitional species: Retain staghorn sumac, pin cherry; supplement with native shrubs with higher wildlife value
- Juniper-Rose-Bayberry Maritime Shrubland: Supplement with raspberry, meadowsweet, and other maritime shrub species
- Oak-Ash Woodland: Expand canopy of oak, ash and native trees; Nurture understory with new native shrubs with high wildlife value.
- Greensward: Reduce mowing frequency of lawns and incorporate small flowering forbs; maintain at 5-7" high